

TYPICAL EAVES DETAIL

" VENTILATED "

" COLD BRIDGING ONLY "

3a

roof to provide a U Value of not less than that shown in TB F1 & F2

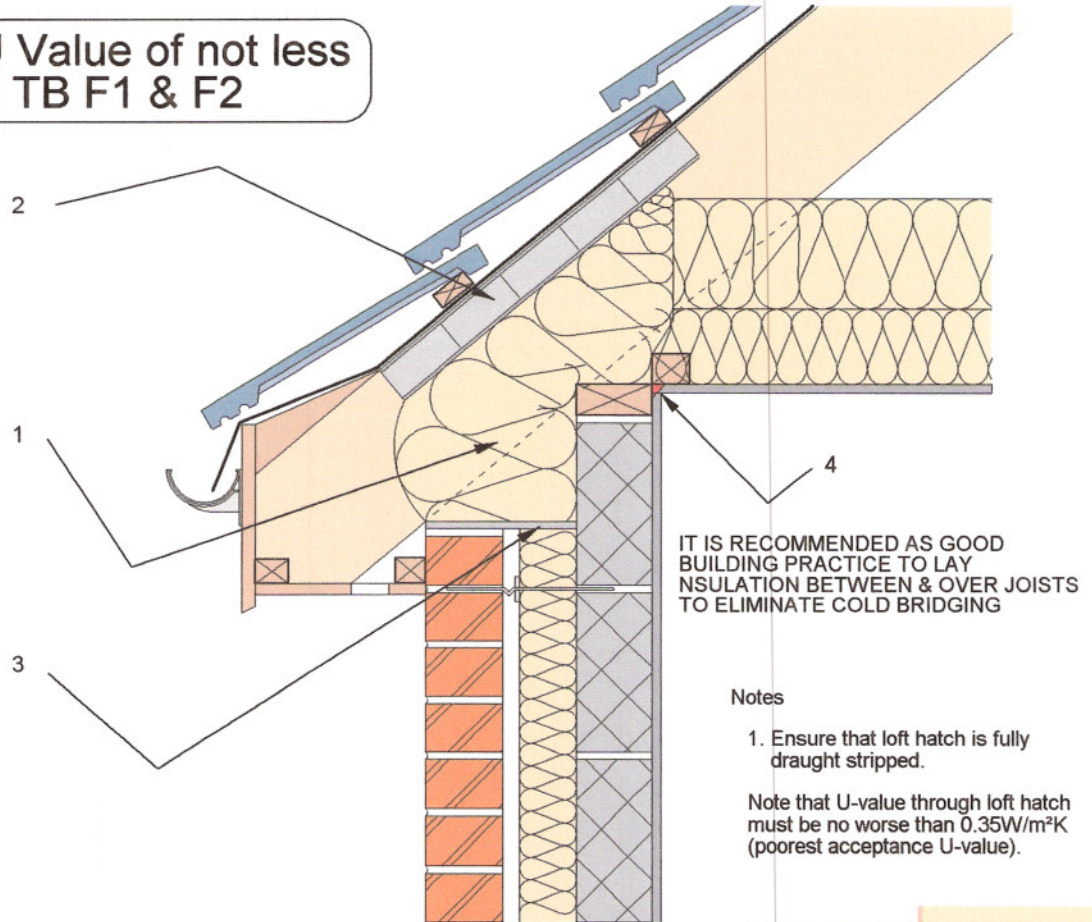

Notes

1. Ensure that loft hatch is fully draught stripped.

Note that U-value through loft hatch must be no worse than $0.35W/m^2K$ (poorest acceptance U-value).

Notes

1. Apply 50mm (min) layer of compressible mineral wool or similar and ensure loft insulation meets wall insulation.
2. Use proprietary crossflow ventilator or ensure air gap if necessary.
3. Fully close cavity with mineral wool or calcium silicate board (shown).
4. Seal all penetrations through air barrier using a flexible sealant.

This detail is also suitable for monopitch roofs subject to suitable ventilation provision.

" NOTE - STANDARDS OF INSULATION TO BE AS DETAILED ON PLANS "

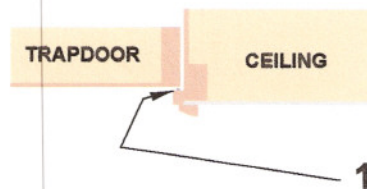

WESTERN GROUP
Building Control Service



*F1 & F2
COMPLIANCE
CHECKLIST*