

# TYPICAL EAVES DETAIL - "NON-VENTILATED"

3b

" COLD BRIDGING ONLY "

roof to provide a U Value of not less than that shown in TB F1 & F2

BEATHABLE FELT FITTED STRICTLY IN ACCORDANCE WITH MANUFACTURER'S SPECIFICATION

PROPRIETARY EAVES CARRIER AS DETAILED BY FELT UNDERLAY MANUFACTURER

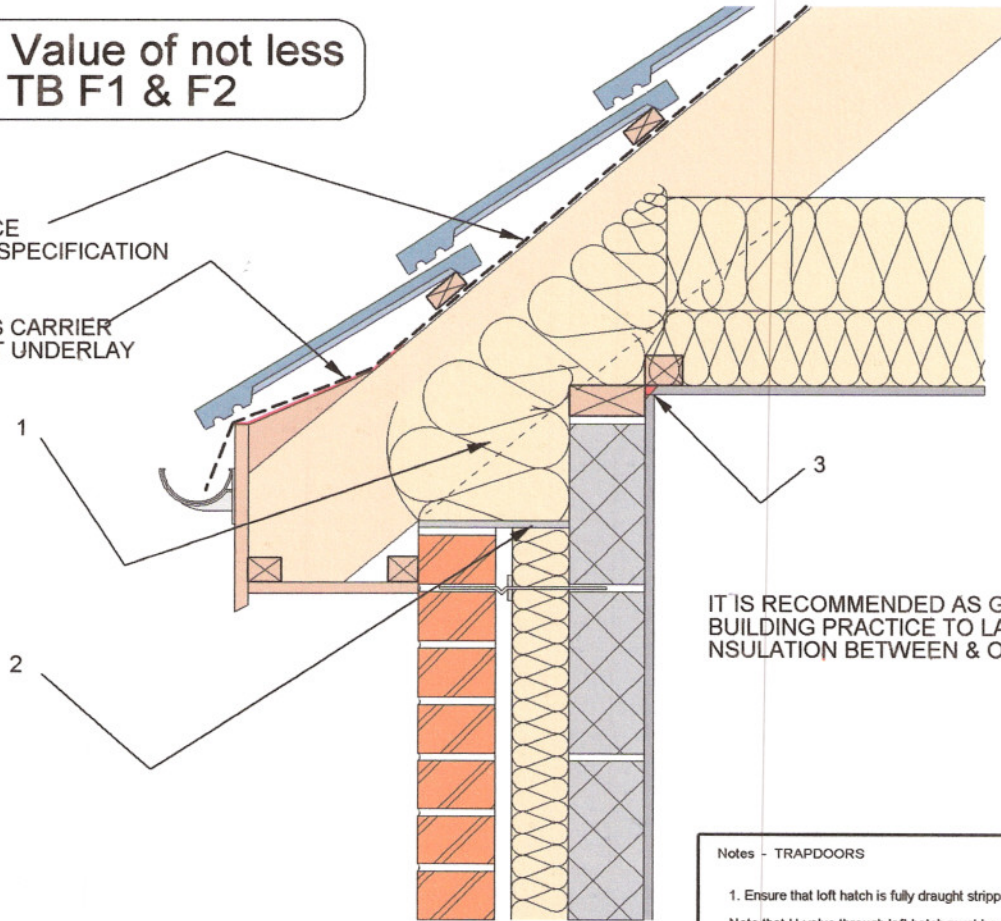

IT IS RECOMMENDED AS GOOD BUILDING PRACTICE TO LAY INSULATION BETWEEN & OVER JOISTS

Notes

1. Apply 50mm (min) layer of compressible mineral wool or similar and ensure loft insulation meets wall insulation.
2. Fully close cavity with mineral wool or calcium silicate board (shown).
3. Seal all penetrations through air barrier using a flexible sealant.

This detail is also suitable for monopitch roofs subject to suitable ventilation provision.

Notes - TRAPDOORS

1. Ensure that loft hatch is fully draught stripped.
- Note that U-value through loft hatch must be no worse than 0.35W/m<sup>2</sup>K (poorest acceptance U-value).

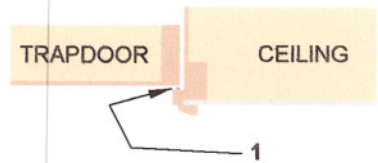

" NOTE - STANDARDS OF INSULATION TO BE AS DETAILED ON PLANS "



**WESTERN GROUP**  
*Building Control Service*



*F1 & F2  
COMPLIANCE  
CHECKLIST*